

Wm. E. Williams No. 1502W2N Class 1500 BW Globe Valve ASTM A 216 WCB (API Trim 8) NACE

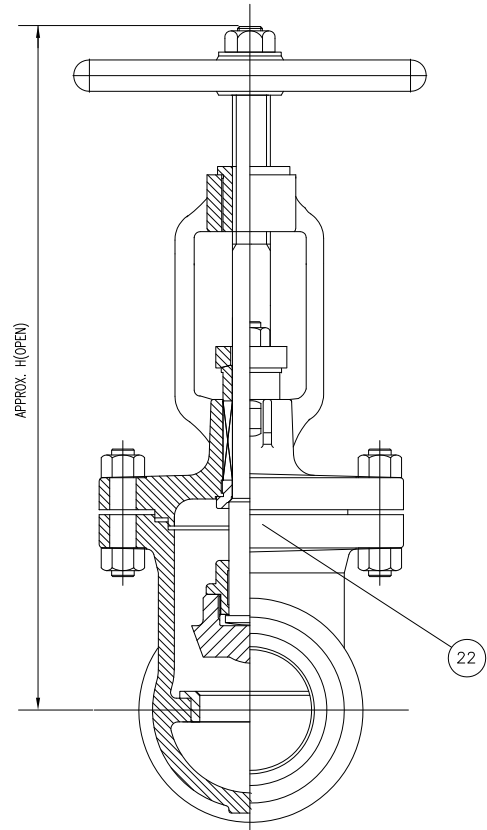

| BILL OF MATERIALS | | | |
|-------------------|--------------|--|------|
| NO. | PART NAME | MATERIALS | Q'TY |
| 1 | BODY | A216Gr WCB | 1 |
| 2 | BONNET | A216Gr WCB | 1 |
| 3 | DISC | A216Gr WCB + 13Cr Faced | 1 |
| 4 | STEM | A479 410 | 1 |
| 5 | SEAT RING | A105N + HF | 1 |
| 6 | BONNET BOLT | A193Gr B7M | 1SET |
| 7 | BONNET NUT | A194Gr 2HM | 1SET |
| 8 | GASKET | 304 + GRAPHITE | 1 |
| 9 | PACKING | GRAPHITE WITH CORROSION INHIBITOR AND DIE FORMED RINGS | 1SET |
| 10 | BACK SEAT | A479Gr 410 | 1 |
| 11 | GLAND RING | A479Gr 410 | 1 |
| 12 | GLAND FLANGE | WCB | 1 |
| 13 | HINGE PIN | 410 | 2 |
| 14 | GLAND BOLT | A193Gr B7M | 2 |
| 15 | GLAND NUT | A194Gr 2HM | 2 |
| 16 | BONNET BUSH | A439Gr D2C | 1 |
| 17 | DISC NUT | A217Gr CA15 | 1 |
| 18 | HAND WHEEL | A197 | 1 |
| 19 | HANDLE NUT | A194Gr 2HM | 1 |
| 20 | SET SCREW | STEEL | 1 |
| 21 | WASHER | STEEL | 1 |
| 22 | NAME PLATE | STAINLESS STEEL | 1 |

| SIZE | d | L | H | W |
|------|------|-------|-------|-------|
| 2.00 | 2.00 | 14.50 | 24.00 | 14.00 |
| 3.00 | 3.00 | 18.50 | 26.00 | 16.00 |
| 4.00 | 4.00 | 21.50 | 28.00 | 18.00 |
| 6.00 | 6.00 | 27.75 | 37.50 | 24.00 |
| 8.00 | 8.00 | 32.75 | 45.00 | 24.00 |

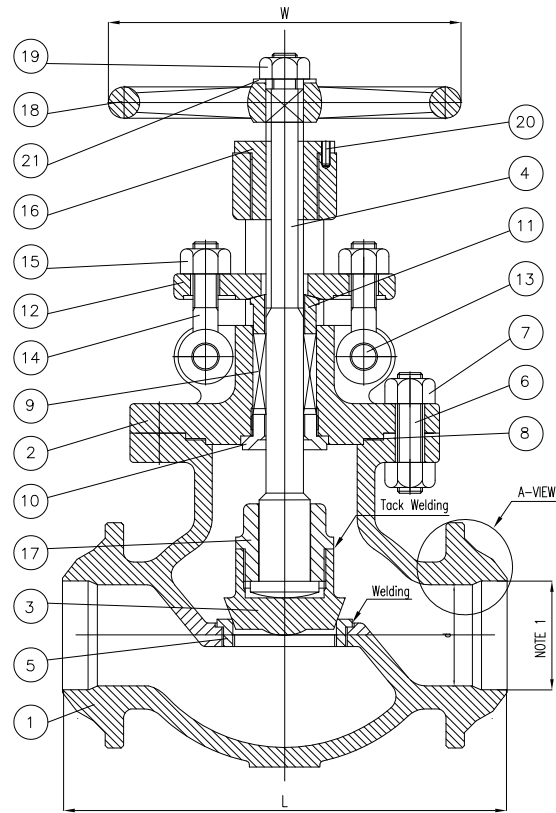
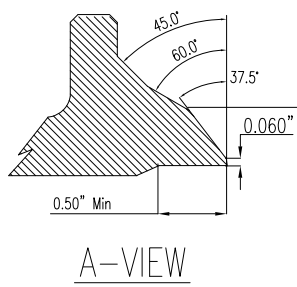

NOTE:
1. SPECIFY PIPE SCHEDULE No. REQUIRED.

Remark: Larger sizes available upon request.

WILLIAM E. WILLIAMS VALVE CORPORATION
 38-52 REVIEW AVENUE LONG ISLAND CITY, NY 11101
 TEL: 718-392-1660 FAX: 718-729-5106
 WWW.WILLIAMSVALVE.COM

TITLE: CAST STEEL GLOBE VALVE
 CLASS 1500 - API TRIM 8 - B,B BUTTWELD END

| | | | | | | | | | | | | | | | |
|-----|------|-------------|-------|-------|-------|-----------------|---------------------|--------------------|---------|-------------------|------------------|---------|-----------|----------|------------|
| | | | | | | MARKING SYSTEM | MSS-SP-25 | INSPECTION & TEST: | API 598 | MATERIAL: | ASTM A216 GR.WCB | UNITS: | Inch, mm | | |
| | | | | | | BUTTWELDING END | ANSI B16.25 | SHELL | HYDRO | 5598PSI | CLASS: | 1500 | DATE: | 01/01/12 | |
| | | | | | | FACE TO FACE | ANSI B16.10 | SEAT | AIR | 80PSI | SIZE: | 2" - 8" | SCALE: | N.T.S. | |
| | | | | | | WALL THICKNESS | BS1873 | BACK SEAT | HYDRO | 4100PSI | DRAWN BY: | F.J. | FIG. No.: | 1502W-2N | |
| NO. | DATE | DESCRIPTION | PRP'D | REV'D | APP'D | DESIGNED | BS1873, ANSI B16.34 | NACE MR | 0175 | CHK'D & APR'D BY: | R.P. | REV: | 1 | DWG No.: | 60GL120127 |