

Class 1500 Swing Check Valve A105N (API Trim 8) NACE

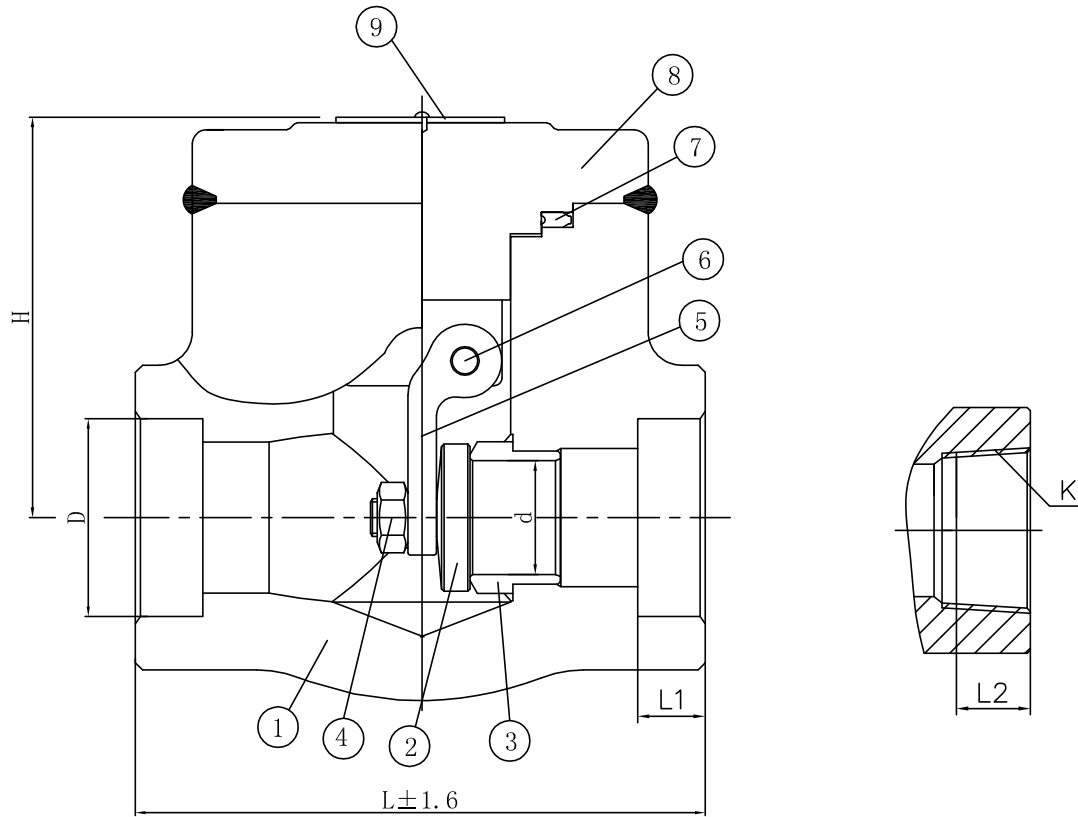

BILL OF MATERIALS			
NO.	PART NAME	MATERIAL	QTY
1	BODY	A105N	1
2	DISC	A276-410	1
3	SEAT RING	A276-410+HF	1
4	NUT	A194 2HM	1
5	ROCKER	304 SS	1
6	DOWEL	A276 304	1
7	GASKET	304+Graphite	1
8	COVER	A105N	1
9	NAME PLATE	STAINLESS STEEL	1

VALVE SIZE		L	d	D	L1	L2	K	H
DN	IN							
15	1/2"	111	φ13	φ21.8	10	15.5	1/2"	79
20	3/4"	111	φ13	φ27.2	13	16.5	3/4"	79
25	1"	120	φ18	φ33.9	13	19.5	1"	97
32	1 1/4"	120	φ24	φ42.7	13	21	1 1/4"	105
40	1 1/2"	140	φ29	φ48.8	13	21	1 1/2"	120
50	2"	178	φ36.5	φ61.2	16	23	2"	140

NO.	DATE	DESCRIPTION	PRP'D	REV'D	APP'D
Δ	1/1/12	ISSUED FOR PROPOSAL			

MARKING SYSTEM	MSS-SP-25	INSPECTION & TEST: API 598		
FACE TO FACE	API 602	SHELL	HYDRO	5598PSI
WALL THICKNESS	BS1868	SEAT	AIR	80PSI
DESIGNED	API 602	BACK SEAT	HYDRO	4100PSI

WILLIAM E. WILLIAMS
VALVE CORPORATION
38-52 REVIEW AVENUE
LONG ISLAND CITY, NY 11101
TEL: 718-392-1660
FAX: 718-729-5106
WWW.WILLIAMSVALVE.COM

TITLE: FORGED STEEL WELDED COVER
SWING CHECK VALVE - CLASS 1500 - API TRIM 8

MATERIAL: A105N **UNITS:** Inch, mm

CLASS: 1500 **DATE:** 01/01/12 **SCALE:** N.T.S.

SIZE: 1/2 - 2" **FIG. No.:**
F1501TXS-2N WB (sw. by thr. ends)
F1501SW-2N WB (sw. ends)
F1501T-2N WB (thr. ends)

DRAWN BY: F.J.

CHK'D & APR'D BY: R.P. **REV:** 1 **DWG No.:** 50SC120236

NACE MR 0175