

# Wm. E. Williams No. FS151F62N 316 Class 150 RF Swing Check Valve F316 (API Trim 12) NACE

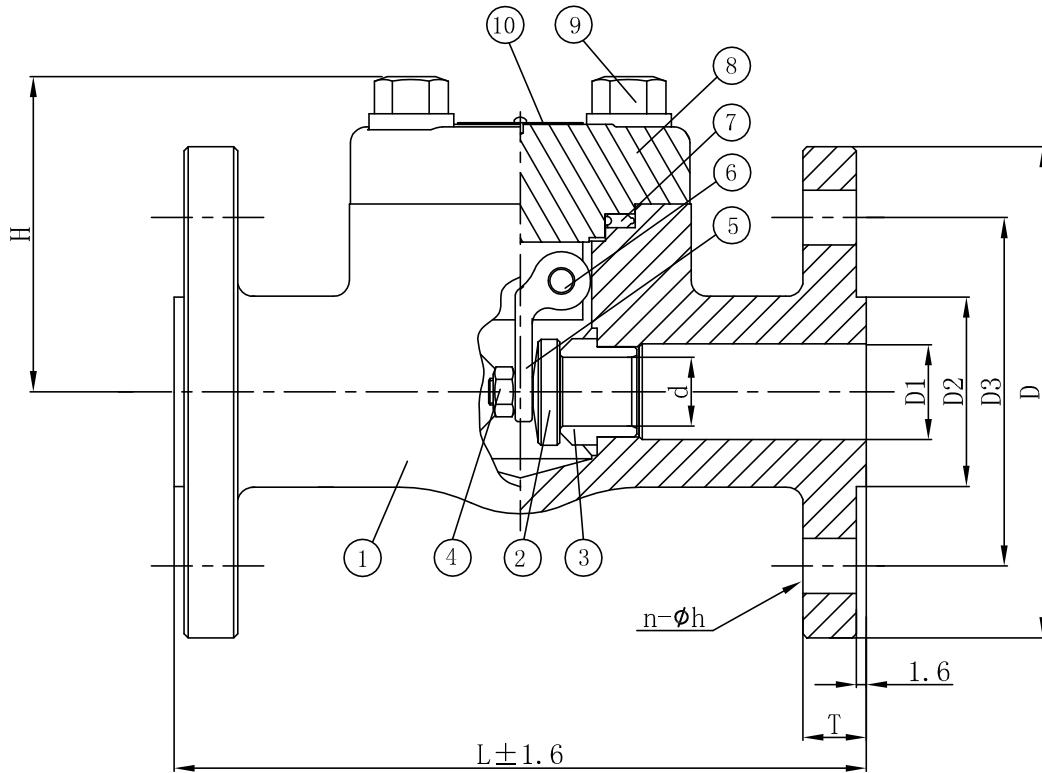

PART NO.	PART NAME	MATERIAL	QTY
1	BODY	A182-F316	1
2	DISC	A276-F316	1
3	SEAT RING	A276-F316 + HF	1
4	NUT	A194 8M	1
5	ARM	F316	1
6	DOWEL	A276-F316	1
7	GASKET	304+Graphite	1
8	COVER	A182-F316	1
9	COVER BOLT	A193 B8M	4
10	NAMEPLATE	STAINLESS STEEL	1

VALVE SIZE		L	d	D1	D2	D3	D	T	H	n-φh
DN	IN									
15	1/2"	108	10	15	35	60.5	89	11.5	62	4-φ16
20	3/4"	117	13	20	43	70	98	13	63	4-φ16
25	1"	127	18	25	51	79.5	108	14.5	78	4-φ16
32	1 1/4"	140	22	32	63.5	89	118	16	82	4-φ16
40	1 1/2"	165	29	40	73	98.5	127	17.5	102	4-φ16
50	2"	203	36	50	92	120.5	152	19.5	120	4-φ20

WILLIAM E. VALVE CORPORATION  
 38-52 REVIEW AVENUE  
 LONG ISLAND CITY, NY 11101  
 TEL: 718-992-1660  
 FAX: 718-729-5166

TITLE: FORGED STAINLESS STEEL BOLTED COVER  
 RF SWING CHECK VALVE - CLASS 150 - API TRIM 12

					MARKING SYSTEM	MSS-SP-25	INSPECTION & TEST: API 598	MATERIAL: F316	UNITS: Inch, mm
					DIM.OF FLANGE	ANSI B16.5	SHELL HYDRO 425PSI	CLASS: 150	DATE: 01/01/12
					FACE TO FACE	ANSI B16.10	SEAT AIR 80PSI	SIZE: 1/2 - 2"	SCALE: N.T.S.
					WALL THICKNESS	BS1868	BACK SEAT HYDRO 325PSI	DRAWN BY: F.J.	FIG. No.: FS151F-62N 316
Δ	1/1/12	ISSUED FOR PROPOSAL			DESIGNED	API 602	NACE MR 0175	CHK'D & APR'D BY: R.P.	REV: 1
NO.	DATE	DESCRIPTION	PRP'D	REV'D	APP'D				DWG No.: 50SC120015