

Wm. E. Williams No. FS601F62N 316 Class 600 RF Swing Check Valve F316 (API Trim 12) NACE

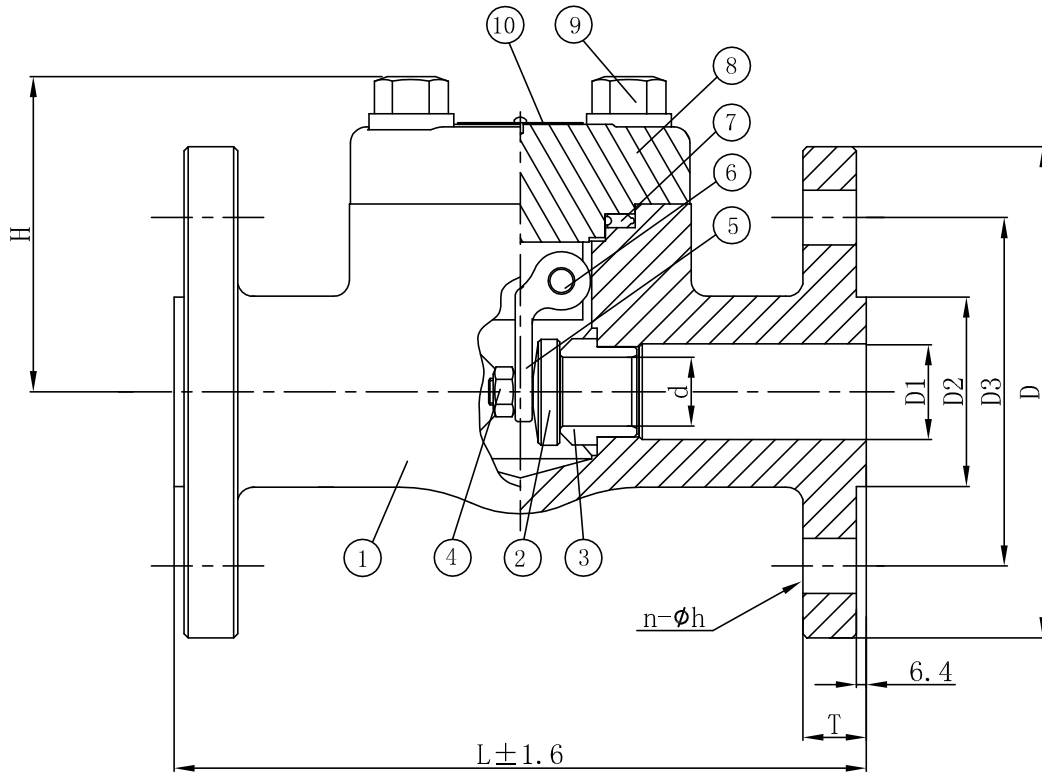

PART NO.	PART NAME	MATERIAL	QTY
1	BODY	A182-F316	1
2	DISC	A276-F316	1
3	SEAT RING	A276-F316 + HF	1
4	NUT	A194 8M	1
5	ARM	F316	1
6	DOWEL	A276-F316	1
7	GASKET	304+Graphite	1
8	COVER	A182-F316	1
9	COVER BOLT	A193 B8M	4
10	NAMEPLATE	STAINLESS STEEL	1

VALVE SIZE		L	d	D1	D2	D3	D	T	H	n-φh
DN	IN									
15	1/2"	165	13	15	35	66.5	95	15	62	4-φ16
20	3/4"	190	18	20	43	82.5	118	16	62	4-φ20
25	1"	216	24	25	51	89	124	18	78	4-φ20
32	1 1/4"	229	29	32	63.5	98.5	133	21	82	4-φ20
40	1 1/2"	241	36.5	40	73	114.5	156	23	102	4-φ22
50	2"	292	49	50	92	127	165	26	120	8-φ20

WILLIAM E. VALVE CORPORATION
 38-52 REVIEW AVENUE
 LONG ISLAND CITY, NY 11101
 TEL: 718-992-1660
 FAX: 718-729-5166

TITLE: FORGED STAINLESS STEEL BOLTED COVER
 RF SWING CHECK VALVE - CLASS 600 - API TRIM 12

					MARKING SYSTEM	MSS-SP-25	INSPECTION & TEST: API 598	MATERIAL: F316	UNITS: Inch, mm
					DIM.OF FLANGE	ANSI B16.5	SHELL HYDRO 2175PSI	CLASS: 600	DATE: 01/01/12
					FACE TO FACE	ANSI B16.10	SEAT AIR 80PSI	SIZE: 1/2 - 2"	SCALE: N.T.S.
					WALL THICKNESS	BS1868	BACK SEAT HYDRO 1600PSI	DRAWN BY: F.J.	FIG. No.: FS601F-62N 316
Δ	1/1/12	ISSUED FOR PROPOSAL			DESIGNED	API 602	NACE MR 0175	CHK'D & APR'D BY: R.P.	REV: 1
NO.	DATE	DESCRIPTION	PRP'D	REV'D	APP'D				DWG No.: 50SC120047