

# Class 800 Welded Bonnet Swing Check Valve F316 (API Trim 12) NACE

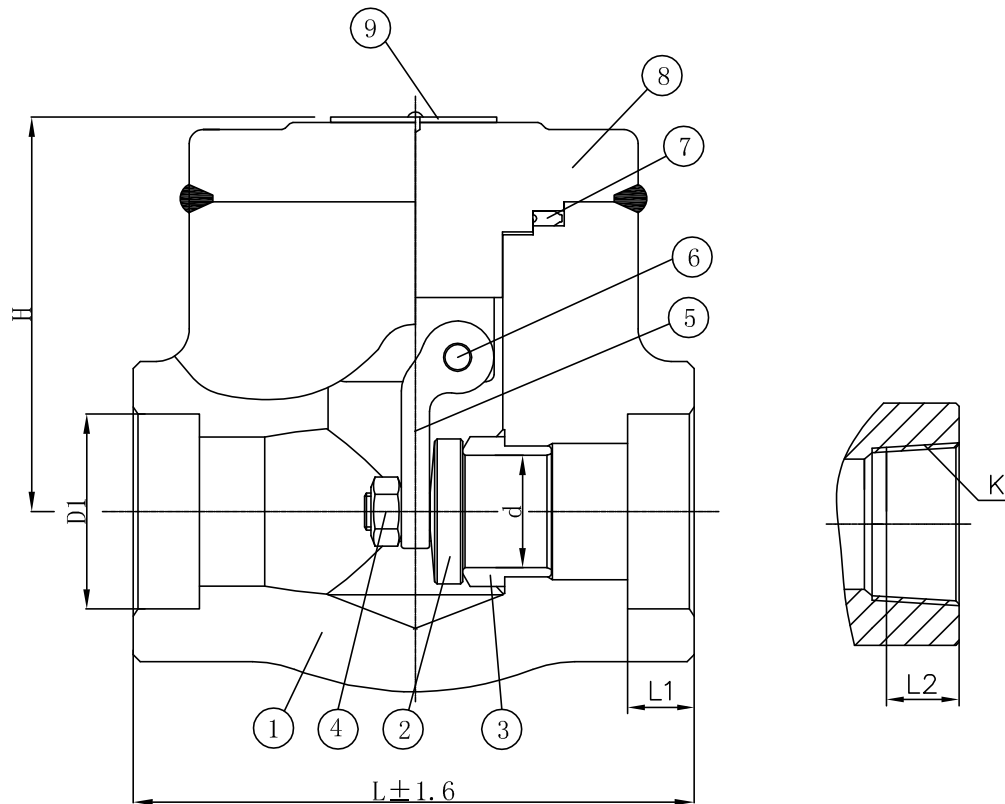

BILL OF MATERIALS			
NO.	PART NAME	MATERIAL	QTY
1	BODY	A182-F316	1
2	DISC	A276-F316	1
3	SEAT RING	A276-F316+HF	1
4	NUT	A194-8M	1
5	ROCKER	F316	1
6	DOWEL	A276-F316	1
7	GASKET	304+Graphite	1
8	BONNET	F316	1
9	NAME PLATE	STAINLESS STEEL	1

Valve Size in	L	d	D1	L1	K	L2	H
1/2"	79	10	21.7	10	1/2"	15.5	62
3/4"	92	13	27.2	13	3/4"	16.5	63
1"	111	18	33.9	13	1"	19.5	78
1 1/4"	120	24	42.7	13	1 1/4"	21	82
1 1/2"	120	29	48.8	13	1 1/2"	21	110
2"	140	36.5	61.2	16	2"	23	120

WILLIAM E. VALVE CORPORATION  
 WWW.WILLIAMSVALVE.COM  
 38-52 REVIEW AVENUE  
 LONG ISLAND CITY, NY 11101  
 TEL: 718-392-1660  
 FAX: 718-729-5106

TITLE: FORGED STAINLESS STEEL WELDED BONNET SWING CHECK VALVE - CLASS 800 - API TRIM 12

MATERIAL: F316 UNITS: Inch, mm

CLASS: 800 DATE: 01/01/12 SCALE: N.T.S.

SIZE: 1/2 - 2" FIG. No.: FS801TXS-62N 316 WB (sw. by thr. ends)

DRAWN BY: F.J. FS801SW-62N 316 WB (sw. ends)

CHK'D & APR'D BY: R.P. REV: 1 DWG No.: 50SC120152

NO.	DATE	DESCRIPTION	PRP'D	REV'D	APP'D	MARKING SYSTEM	MSS-SP-25	INSPECTION & TEST: API 598
						FACE TO FACE	API 602	SHELL HYDRO 3046PSI
						WALL THICKNESS	BS1868	SEAT AIR 80PSI
						DESIGNED	API 602	BACK SEAT HYDRO 2234PSI
								NACE MR 0175

1/1/12	ISSUED FOR PROPOSAL			
--------	---------------------	--	--	--